

Sd = 200 mm

- internal and external Teach-in
- small sonic beam angle
- compact housing



general data

sensing range sd	0 ... 200 mm
reflector position Sde	40 ... 200 mm
adjusting range reflector (operating range)	± 2,5% Sde
adjusting range reflector (limit range)	± 5% Sde
repeatability	< 1,5 mm
alignment aid	target display flashing
adjustment	Teach-in
temperature drift	< 2% Sde
response time ton	< 10 ms
release time toff	< 10 ms
sonic frequency	380 kHz
output indicator	LED green

electrical data

voltage supply range +Vs	12 ... 30 VDC
current consumption max.	35 mA
output current	< 200 mA
voltage drop Vd	< 2 VDC
residual ripple	< 10% Vs
short circuit protection	yes
reverse polarity protection	yes

mechanical data

type	rectangular
housing material	polyester
width / diameter	20 mm
height / length	42 mm
depth	15 mm
connection types	connector M8

ambient conditions

operating temperature	-10 ... +60 °C
protection class	IP 67

accessories

connectors	ESW 31A, ESG 32A
------------	------------------

order reference

order reference	output circuit
URDK 20N6914/S35A	NPN make function (NO)
URDK 20N7914/S35A	NPN break function (NC)
URDK 20P6914/S35A	PNP make function (NO)
URDK 20P7914/S35A	PNP break function (NC)

dimension drawing

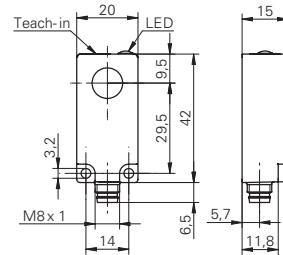

connection diagrams

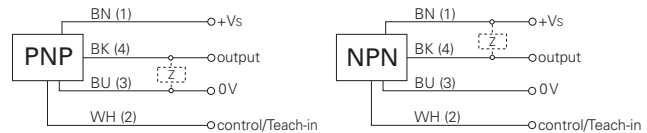

typical sonic cone profile

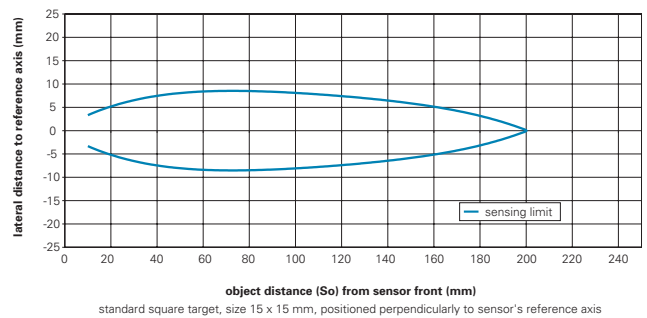

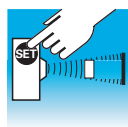

Sd = 400 mm

- internal and external Teach-in
- wide sonic beam angle
- compact housing



general data	
sensing range sd	0 ... 400 mm
reflector position Sde	100 ... 400 mm
adjusting range reflector (operating range)	± 2,5% Sde
adjusting range reflector (limit range)	± 5% Sde
repeatability	< 1,5 mm
alignment aid	target display flashing
adjustment	Teach-in
temperature drift	< 2% Sde
response time ton	< 25 ms
release time toff	< 25 ms
sonic frequency	290 kHz
output indicator	LED green

electrical data	
voltage supply range +Vs	12 ... 30 VDC
current consumption max.	35 mA
output current	< 200 mA
voltage drop Vd	< 2 VDC
residual ripple	< 10% Vs
short circuit protection	yes
reverse polarity protection	yes

mechanical data	
type	rectangular
housing material	polyester
width / diameter	20 mm
height / length	42 mm
depth	15 mm
connection types	connector M8

ambient conditions	
operating temperature	-10 ... +60 °C
protection class	IP 67

accessories	
connectors	ESW 31A, ESG 32A

order reference	output circuit
URDK 20N6912/S35A	NPN make function (NO)
URDK 20N7912/S35A	NPN break function (NC)
URDK 20P6912/S35A	PNP make function (NO)
URDK 20P7912/S35A	PNP break function (NC)

dimension drawing

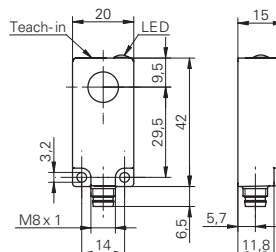

connection diagrams

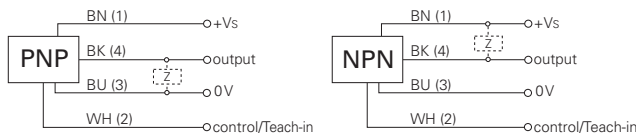

typical sonic cone profile

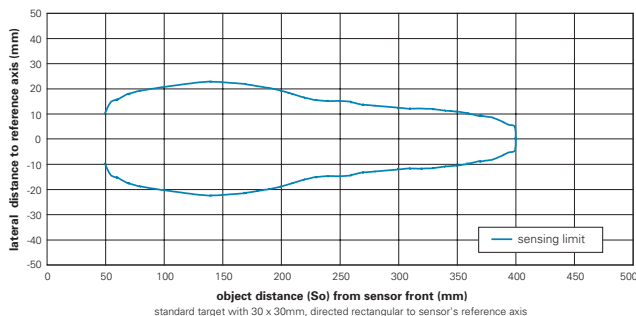

URDK 20 Sd = 400 mm

Ultrasonic retro-reflective sensors



Sd = 1000 mm

- internal and external Teach-in
- small sonic beam angle
- compact housing



general data

sensing range sd	0 ... 1000 mm
reflector position Sde	200 ... 1000 mm
adjusting range reflector (operating range)	± 2,5% Sde
adjusting range reflector (limit range)	± 5% Sde
repeatability	< 1,5 mm
alignment aid	target display flashing
adjustment	Teach-in
temperature drift	< 2% Sde
response time ton	< 50 ms
release time toff	< 50 ms
sonic frequency	240 kHz
output indicator	LED green

electrical data

voltage supply range +Vs	12 ... 30 VDC
current consumption max.	35 mA
output current	< 200 mA
voltage drop Vd	< 2 VDC
residual ripple	< 10% Vs
short circuit protection	yes
reverse polarity protection	yes

mechanical data

type	rectangular
housing material	polyester
width / diameter	20 mm
height / length	42 mm
depth	15 mm
connection types	connector M8

ambient conditions

operating temperature	-10 ... +60 °C
protection class	IP 67

accessories

connectors	ESW 31A, ESG 32A
------------	------------------

order reference output circuit

URDK 20N6903/S35A	NPN make function (NO)
URDK 20N7903/S35A	NPN break function (NC)
URDK 20P6903/S35A	PNP make function (NO)
URDK 20P7903/S35A	PNP break function (NC)

dimension drawing

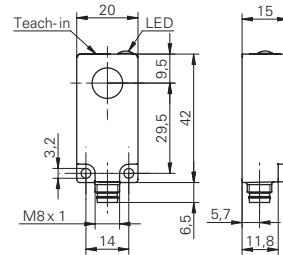

connection diagrams

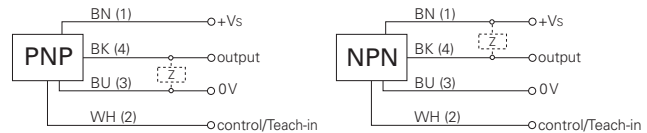

typical sonic cone profile

